

FAITH LUTHERAN CHURCH  
50 LEVERSEE ROAD  
TROY, NEW YORK 12182



# ***Following Faith***

***November 2020***



## ***Thanksgiving Prayer***

*Heavenly Father, on Thanksgiving Day  
We bow our hearts to You and pray.  
We give You thanks for all You've done  
Especially for the gift of Jesus, Your Son.  
For beauty in nature, Your glory we see.  
For joy and health, friends and family.  
For daily provision, Your mercy, and care.  
These are the blessings You graciously share.  
So today we offer this response of praise  
With a promise to follow You all our days.*



Dear friends,

For as much as I love October and its colors, flavors, and temperatures, I don't really have those same happy feeling about November! There's a sharper feel to some of the changes we notice now – less daylight and colder temperatures, and also a dulling of the contrasts outdoors – bright colors replaced by more brown and gray. I am apt to notice the light in November also. Once the leaves come off the trees, the brighter light of the sun is more revealing – a bit more intense, maybe.

I think that this mixes and matches well with what we are experiencing during this season of the church year also. The 'season' of November (unofficial, but still noteworthy!) is one of somewhat harsher light on the truth of our mortality. The first Sunday of the month is All Saints' Sunday (falling this year on All Saints' Day – November 1<sup>st</sup>!) – a day to honor and give thanks for the lives of those we knew and loved – those who now rest in the bright light of God's presence. The next two Sundays take up what we call 'the end times' – a challenging period of transition before we reach – and celebrate – the Reign of Christ on Christ the King Sunday – November 22.

We get to add a fifth Sunday to this month – which will usher in the beloved season of Advent – and the lovely shade of blue and waiting . . .

Looking forward to walking with you through the seasons,

Pastor Judy

**Faith Lutheran Church  
50 Leverage Road  
Troy, New York 12182  
(518) 237-4641**

[www.faithlutherantroy.com](http://www.faithlutherantroy.com)

**Sunday morning virtual worship: 10:00 a.m.**

**Rev. Judith Converse, Pastor  
(Stewardship)**

**Church Council Officers:**

**Diana Rieker (President)  
Bill Jarosz (Vice President)  
Carol Karpien (Secretary)  
Roberta Hayward (Treasurer)  
Rich Anderson (Financial Secretary)**

**Council Members**

**Errol Bull (Property)  
Fred Howard (Special Projects)  
Linda Hulihan (Stewardship)  
Bill Jarosz (Property)  
Sara Martin (Education)  
Carol Perrott (Inreach/Outreach)  
Donna St. John (Missions)**

**R. Hayward, F. Howard, B. Jarosz,  
and C. Karpien (Partnership Council)**

**Barbara Boord, Newsletter Editor**

**ELECTRONIC SERVICES WILL CONTINUE  
TO BE HELD UNTIL FURTHER NOTICE.  
INSTRUCTIONS FOR PARTICIPATION AS  
WELL AS SERVICE MATERIALS WILL BE  
SENT BY EMAIL AND BY US MAIL.**

# WELCOME BACK!

With respect to our indoor worship and in-person, we want to remind you of a couple things:

- PLEASE do a quick health screening before you come to church. If you are feeling ill at all, do not leave your home. Attend our worship service via Zoom at 10:30 a.m.
- Bring your mask – and wear it over your mouth and nose! Everyone attending worship in-person must wear a mask.

When you arrive at church, enter the narthex through the east or west doors. Keep six feet between you and others.

Provide your name and phone number to the check-in person. This is for contact tracing. We also ask you to sanitize your hands.

Move towards the center aisle, take a bulletin from the table, place your offering in the plate (THANK YOU!), and allow the usher to help you find a seat.

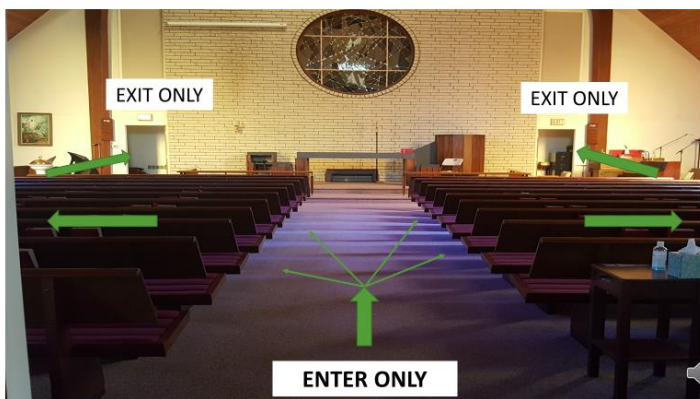

Stay seated during the entire worship service. At the end of the service, exit through the doors at the front of the sanctuary.

If you need to use the restroom during the service, please follow the arrows. Only one person/ family at a time should be in the restroom.

Currently we will not be singing during in-person worship or offering Holy Communion. We also cannot provide a coffee hour following worship.

If you have any questions, please contact a Council member or Pastor Judy.

## RE-OPENING 'JOBS'

As we gather again inside and in-person this Fall, a few volunteers are needed to insure our safety and comfort:

- Check-in – two people sit at the check-in table to verify names and phone numbers for everyone attending
- Ushers – one or two people to escort worshipers to seats that are distanced from others
- Narthex person/ floater – one person to be available for questions
- 

If you would like to volunteer for any of these tasks, please contact a Council member or Pastor Judy.

## November Worship Schedule

November 1 – In-person worship at Evangelical Lutheran/ Poestenkill at 9:00 a.m.  
Worship via Zoom at 10:30 a.m.

November 8 – In-person worship at Faith Lutheran/ Troy at 9:00 a.m.  
Worship via Zoom at 10:30 a.m.

November 15 – In-person worship at Evangelical Lutheran/ Poestenkill at 9:00 a.m.  
Worship via Zoom at 10:30 a.m.

November 22 – In-person worship at Faith Lutheran/ Troy at 9:00 a.m.  
Worship via Zoom at 10:30 a.m.

November 29 – In-person worship at  
Evangelical Lutheran/ Troy at 9:00 a.m.  
Worship via Zoom at 10:30 a.m.



## **OUR FAITH at WORK**

\* \* \* \* \*

### **AMONG OUR PEOPLE**

**A Thank You from the Molesky Family**

**The Congregation of Faith Thank you for all the cards and prayers.**

**Your Friendship, cards and prayers have helped us through this very sad time.**

**Blessings,**

**Joann and Family**

**Please pray for Brayden McCormack, and his family. Brayden is a 9-year-old boy from Tampa, Florida who has unfortunately contracted Naegleria Fowleri a Brain-eating amoeba.**

**This single-cell amoeba attacks brain tissue and is usually fatal.**

**His continued strength, along with our loving prayers, will support his healing and recovery.**

**Prayers for Larry Boord who is now home and continuing his recovery process. Please include Barbara as well.**

**Prayers of encouragement for Pastor Judy and the Councils of Faith and Evangelical as they lead our congregations into a new journey of Faith in our communities.**

**And finally, prayers for our country and our world in these times of COVID-19 pandemic and turmoil and unrest.**

### **NOVEMBER MISSION**

The featured mission for the month of November is **Joseph's House.**

Joseph's House, located in downtown Troy, provides emergency shelter and/or support services to an average of 1,000 men, women, and children yearly. Central to Joseph's House mission is to provide non-judgmental services to end homelessness. Treating each person with dignity & respect, and promoting self-determination empowers guests and tenants to make healthier choices.

### **PULL TABS**

We continue to collect the pull tabs off soda or beer cans. Donated pull tabs will be periodically dropped off to the Ronald McDonald House, in Albany. You will find the collection containers on the table in the Narthex. Your continued support is greatly appreciated. Ronald McDonald House Charities of the Capital Region not only provides access to quality health care; we enable a family-centered approach, ensuring families are fully supported and actively involved in their children's care. For more information check out the website:

<https://rmhcofalbany.org/>

### **BREAD OF LIFE FOOD PANTRY.**

Our mission of the month is the Bread of Life Food Pantry which is located next to Evangelical Church in Poestenkill. It is a nonprofit organization helping families supplement their food needs. Our church has been supporting the food pantry with food donations left in the collection box in the Narthex. While the church is closed, the need continues. You may choose to bring donations directly to Evangelical Church in Poestenkill. You may drop

off your donations during the daytime. Volunteers will check Monday, Wednesday, Friday. If you wish, you may leave a message at the church office number (518) 283-6045 to let them know when you will be dropping off a donation.

**“BREAD OF LIFE” FOOD PANTRY**  
 STAPLE FOOD SUGGESTIONS TO  
 SHOP FOR OR DONATE – **ELCP Poestenkill, NY**

**Meat Items:** hamburger (1lb.) bacon (1lb.) hot dogs, frozen chicken (tenders, nuggets, patties) Frozen fish (sticks, fillets) Eggs, American cheese slices, butter (1 lb.), bread & rolls  
**Canned or jarred items:** Vegetables (green beans, corn, peas, potatoes, beets, carrots) Fruit (peaches, pears, pineapple, **fruit cocktail, Mandarin oranges**, applesauce)  
 Pork & Beans, any like Bush’s baked beans, canned pasta (ravioli, beef-a-roni, spaghetti)  
 Peanut Butter, jelly (**strawberry**, grape, others), fruit juices (apple, cranberry, other varieties) snack items (cookies, bars, pudding, fruit cups, cake & baking mixes, any others)  
 Canned Tuna, Stew, Chili, or **Hash** – Soups (chicken noodle, tomato, or any kind) -Spaghetti sauce – Mayo, Mustard, Ketchup  
 Coffee (instant or ground) Tea bags, Sugar, Flour, cooking oil, dried pasta (any kind) Pancake or Baking Mix, rice (white or brown), Pancake syrup  
 Stuffing Mix, dried Potato Mixes, Mac & Cheese, Ramen Noodles, Cereal (cold or hot) Oatmeal, Cheerios, Frosted Flakes, Mini-Shredded Wheat, Cinnamon Toast Crunch, Cinnamon Life, Honey Nut Cheerios, Life, Raisin Bran, Chocolate varieties, Froot Loops, Lucky Charms  
**Personal Items:** Bar soap, deodorant, toothpaste, toothbrush, shampoo, **dish soap, laundry soap**, toilet paper, paper towels, tissues  
**Fresh Produce:** Potatoes, carrots, onions, oranges, apples, garden abundance in summer **THANKS FOR YOUR SUPPORT!**  
 Call (518) 283-6045 for shopping list or to drop off at the church.

*Donna St. John, Missions*

**THANKSGIVING AND CHRISTMAS  
 BASKETS 2020**

As we begin our preparations for the Thanksgiving and Christmas season, let us Thank God for all his gracious gifts, and pray for all those who struggle through this time with emotional and financial difficulty.

**This year because of COVID 19, we will be collecting only monetary donations to help families in need during the Holidays. Donation envelopes will be available in the back of the church if you choose to donate through our church offering, OR, we are happy to accept them personally. You can also make your donation directly to the church by mail ATT. LouAnn Behrens or Pat Turcotte. Together we can make this happen. Blessings and please be safe.**

**Thank You,  
 LouAnn Behrens**



**Nov. 1 To the Glory of God**

**Nov. 8 In memory of Arthur and Heldwig Ude.  
 Given by Barbara Morgan.**

**In memory of Pastor Cordes and Pastor Hempel.  
 Given by the Howards.**

**Nov. 15 To the Glory of God**

**Nov. 22 To the Glory of God**

**Nov. 29 To the Glory of God**

**SERVING FAITH – ALTAR GUILD**

Good morning,

We will be waiting to set an altar schedule. During this restricted time, I will change banners and linens as needed. When we begin offering communion again, I will also plan to set that up

for now. Please call me if there are any special needs.

**Donna St. John**  
**518-274-3539 home**  
**518-526-2545 cell**



## **JOINT PRAYER GROUP**

Faith Lutheran and Evangelical Lutheran have a Joint Prayer Group that has been active since June 2016. There are approximately 12 of us that pray on a regular basis for our churches, for our Pastor and for healing for our members and others in need of prayer.

Pray for wisdom for our church leaders as we plan how we as congregations will worship together in the future.

Pray for spiritual revival in this area. Pray also for the churches in this area that are struggling and in need of pastors.

If you, a loved one, or someone you know would like to be included on the specific list for prayers, please let me know.

Michele Howard, [mcvh44@aol.com](mailto:mcvh44@aol.com), (518) 753-4288.

## **NEWSLETTER COORDINATOR**

Barbara Boord is coordinating the Newsletter efforts.

Newsletter copies may be viewed on the church web site: [www.faithlutheranchurchtrov.com](http://www.faithlutheranchurchtrov.com) at any time.

We will email you a copy if you send your email address directly to Barbara at: [barbboord@hotmail.com](mailto:barbboord@hotmail.com).

Finally, at your request, we will be happy to send you a hard copy via the USPS.

## **NEWSLETTER DEADLINE**

The newsletter item deadline for the December 2020 newsletter is Monday November 23rd. Please email your articles to: [barbboord@hotmail.com](mailto:barbboord@hotmail.com).

**I would like to take this opportunity to thank all the dedicated individuals who have contributed, and assisted with the publishing of the Faith Lutheran Newsletter during my tenure as Editor.**

**My time as Editor is coming to an end. Larry and I are moving after the New Year to Little River, South Carolina.**

**It has been a pleasure working with all the people of Faith. Not only on the Newsletter but also on other worthwhile activities at Faith. Least of which was on Faith Council.**

**Larry and I will miss our friends and church family and extend an open invitation to anyone who wants to visit.**

**God Bless and Keep you all,  
Barbara**



**ELCA Prayer for Times of Public Health  
Concern: COVID-19/Coronavirus**

**God, our peace, and our strength, we pray for our nation and the world as we face new uncertainties around coronavirus. Protect the most vulnerable among us, especially all who are currently sick or in isolation. Grant wisdom, patience, and clarity to health care workers, especially as their work caring for others puts them at great risk. Guide us as we consider how best to prepare and respond in our families, congregations, workplaces, and communities. Give us courage to face these days not with fear but with compassion, concern, and acts of service, trusting that you abide with us always, through Jesus Christ our Lord. Amen.**

## IN-PERSON, INDOOR WORSHIP!

Going forward the indoor/ in-person worship service will alternate between Evangelical and Faith Lutheran, each week at 9:00 a.m., AND the 10:30 Zoom worship would continue to be offered.

If you would like to receive OR continue to receive a weekly mailing of the Zoom worship bulletin, please call the church office (518 237 4641) and leave a message with your name and plan to continue. Thank you!

Here are some of the guidelines for our in-person worship:

- **Please, please do not come to in-person worship if you feel ill!** The symptoms of the virus are well-known – fever, shortness of breath, and achiness. Especially as we move into the Fall and flu season, we all need to be careful about spreading any illness to others when we are together.
- If you come to in-person worship, **a mask will be required.** That mask should cover your nose and mouth fairly snugly. Please have it on when you enter the building. Masks will also be available at the check-in table.
- Upon entering, you will be asked to sanitize your hands.
- We will ask you to verify your name and phone number for tracking purposes should someone present that day develop COVID-19.
- We ask that you **remain at least 6 feet away from others.** That includes when you are entering or leaving – and when you are sitting. The pews in the sanctuary will be marked to indicate where you can sit. Those from the same household can sit together.
- Please enter through the narthex – either the east or west doors. An usher will assist you in via the center aisle to a pew. All exiting will be from the side aisles and through the doors at the front of the sanctuary – near the library and the sacristy.
- An offering plate will be available in the center aisle for your envelope. THANK YOU!
- A bulletin will be available for use during the service.
- If you need to use the restroom while you are in the building, please allow only one person in the room at a time. Use the disinfectant wipes that are available.

Initially we will not be singing hymns or partaking in Holy Communion. These additions to our service may be added as we move forward.

If you have any questions or concerns, please contact a Council member or Pastor Judy. Be safe.